

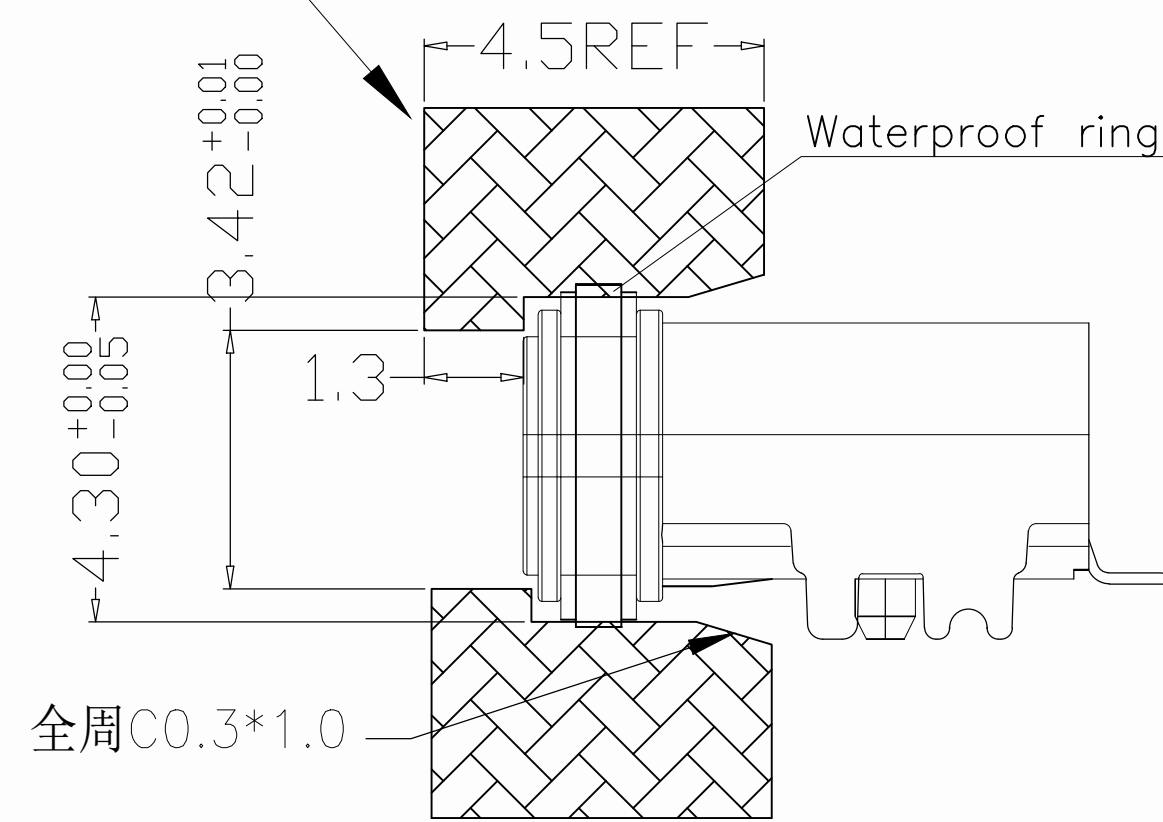

参考机壳面板

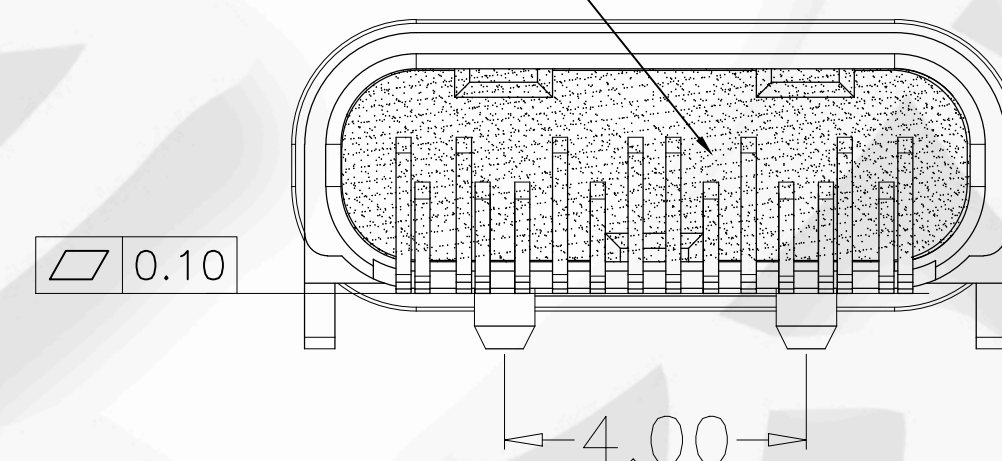

此处点胶



901-00CP-0541

- 产品流水号
- 系统成品名称
- (01 Au:1u") (03 Au:3u")
- (05 Au:5u") (15 Au:15u")
- (30 Au:30u") (15 Au:15u")
- 系统成品编码

USB TYPE-C PIN ASSIGNMENTS

A1	GND	B12	GND
A4	VBUS	B9	VBUS
A5	CC1	B8	SBU2
A6	DP1	B7	DN2
A7	DN1	B6	DP2
A8	SBU1	B5	CC2
A9	VBUS	B4	VBUS
A12	GND	B1	GND
PIN	SIGNAL NAME	PIN	SIGNAL NAME

RECOMMENDED P.C.B. LAYOUT
TOLERANCE UNSPECIFIED ±0.05mm

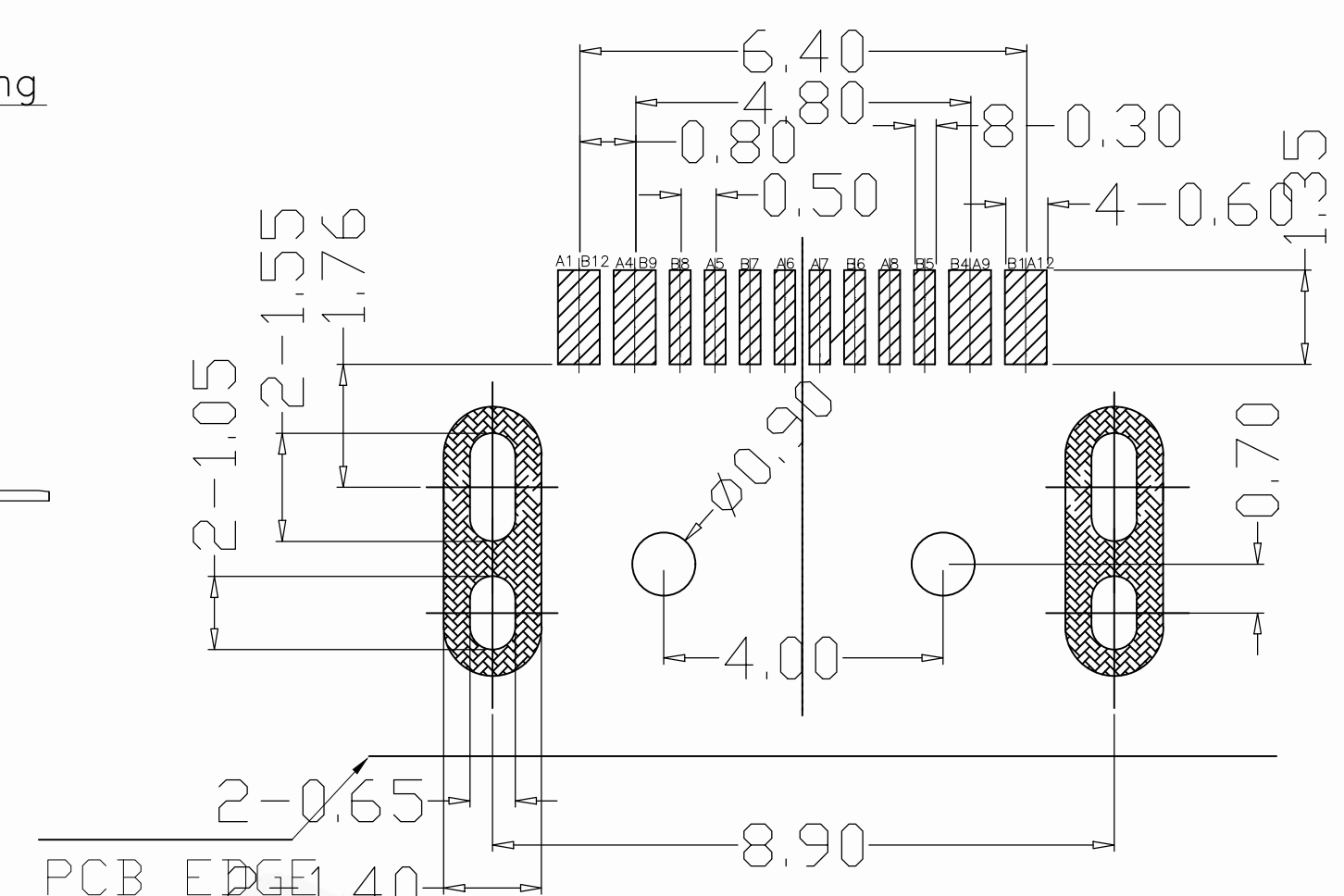

NOTE:

- 1.MATERIAL SPECIFICATION:
 - 1.HOUSING:PA9T,UL94 V-0 Black.
 - 2.CONTACTS:COPPER C7025,t=0.20mm
 - 3.MID PLATE: STAINLESS STEEL SUS t=0.15mm
 - 4.Shell:Zinc Alloy,
 - 5.Waterproof ring: red silicone
- 2.PLATING SPECIFICATION:
 - 2-1.CONTACTS:
 - Ni 50u" MIN. UNDER PLATED OVER ALL.
 - Au1~30u"min PLATED ON THE FUNCTIONAL AREA OF CONTACT.
 - (GOLD PLATING THICKNESS FOLLOW THE P/N)
 - PLATING SPECIFICATIONS OF THE SOLDER AREA FOLLOW THE G/F
 - 2-2.SHELL:
 - Ni 100u". UNDER PLATED OVER ALL.
 - 2-3.MID PLATE:
 - CLEAR ONLY
- 3.MECHANICAL PERFORMANCE,
 - 3-1.INSERTION FORCE: 5~20N.
 - 3-2.REMOVAL FORCE: 8~20N,AFTER TEST: 6~20N
 - 3-3.FREQUENCE: 200±50 CYCLES/HOUR,10000 CYCLES.
- 4.ELECTRICAL PERFORMANCE,
 - 4-1. CURRENT RATING:5.0A
VOLTAGE RATING:20.0V
 - 4-2. INITIAL LLCR 40mΩ MAX,AFTER TEST 50mΩ MAX
 - 4-3.INSULATION RESISTANCE: 100MΩ MIN
 - 4-4.DIELECTRIC WITHSTAND VOLTAGE,AC 100V FOR 1 MINUTE.
5. ENVIRONMENTAL PERFORMANCE:
 - 5-1.OPERATING TEMPERATURE: -40°C~+80°C.
 - 5-2.SALTY SPRAY: 24HOURS
- 6.IR REFLOW:
 - THE PEAK TEMPERATURE ON THE BOARD SHALL BE MAINTAINED FOR 10 SECONDS AT 260°C.
- 7.WATERPROOF: IP-X7.

CUSTOMER DRAWING

UNITS mm	SCALE 1:1	SHEET
PROJECTION: 	DRAW: DAP	
GENERAL TOLERANCE XX ± .XXX ± .X ± 0.20 .XXX ± .XX ± 0.15 .X' ± 2' .XXX ± 0.10 .X' ± 0.5'	CHECK: HWT	APPD: HHM

铭创科技（东莞）有限公司

TITLE
16PIN 防水TYPE C母座 板上四脚插板
锌合金 L=7.5

MAT'L
SEE TABLE

FINISH
SEE TABLE

DWG. NO.
0492. WPCF. 16BS. H3

PART NO. _____

SIZE
A4

