

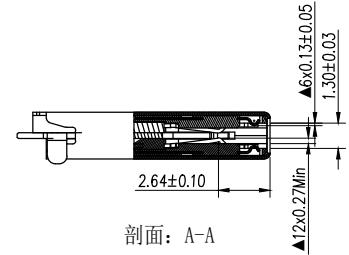

REV	DESCRIPTION	DATE	APPROVED

Specification:

- Electrical Characteristics:
 - Contact Current Rating: 3 Amperes Max.
 - Rated Voltage: 30V Max.
 - Dielectric Withstanding Voltage: AC 100V r.m.s.
 - Insulation Resistance: 100 MΩ Minimum.
 - Contact Resistance: 40 mΩ Maximum.
- Environmental:
 - Operating Temperature: -30°C~+85°C.
- Mechanical Characteristics:
 - Insertion Force: 5~20Nf.
 - Withdrawal Force: 8~20Nf.
 - Durability Cycles: 10000 Cycles.

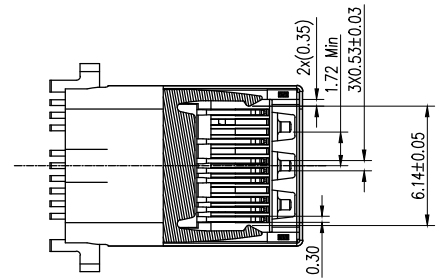
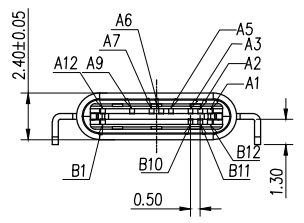
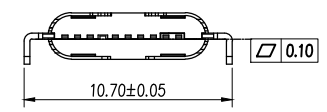
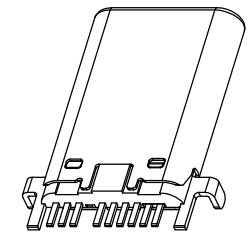
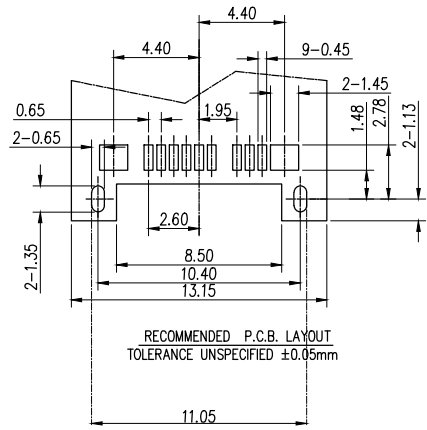
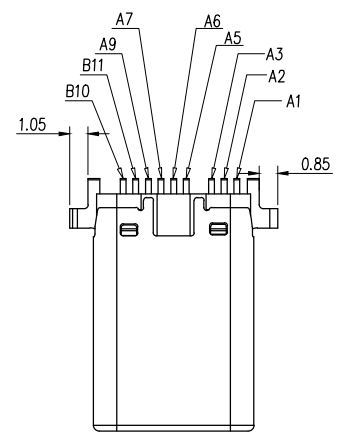

5	EMC SPRING	Stainless Steel; SUS201, T=0.10mm;
4	CONTACT	Copper Alloy; AuNiSn;
3	LATCH	Stainless Steel; SUS301, T=0.3mm;
2	HOUSING	LCP Thermoplastic; UL94V-0;
1	SHELL	Stainless Steel; SUS316, T=0.15mm;
NO.	NAME	DESCRIPTION

A12	A11	A10	A9	A8	A7	A6	A5	A3	A2	A1	
			VBUS		D-	D+	CC		TX1-	TX1+	GND
									RX1-	RX1+	
B1	B2	B3	B4	B5	B6	B7	B8	B9	B10	B11	B12

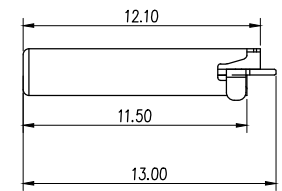
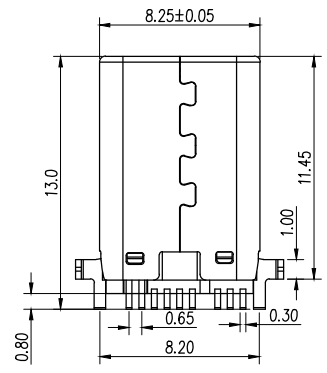

CUSTOMER DRAWING			铭创科技（东莞）有限公司 Mingchuang Technology (Dongguan) Co., Ltd		
UNITS mm	SCALE 1:1	SHEET	TITLE TYPE C公头9PIN 沉板0.95 两脚插板SMT L=10.05 铆合		
PROJECTION: 	DRAW: DAP	CHECK: HWT	MAT'L SEE TABLE	FINISH SEE TABLE	
GENERAL TOLERANCE 0. ±0.20 0.0 ±0.15 0.00 ±0.10 0.° ±2° 0.0° ±1°	APPD: HHM	DWG. NO. 1281. TCM. 9CB. W9	PART NO.	SIZE A4	